

BPIR DECLARATION

Broadloom Carpet



Version: V1 December 2023

DESIGNATED BUILDING PRODUCT: Class 1

DECLARATION

Godfrey Hirst NZ Ltd. has provided this declaration to satisfy the provisions of Schedule 1(d) of the Building (Building Product Information Requirements) Regulations 2022.

COMPANY DETAILS

Importer:

Legal Trading Name: Godfrey Hirst NZ Limited
NZBN: 9429040592015
Address: 142 Kerrs Road, Wiri, Auckland 2104
Email: info@godfreyhirst.co.nz
Website: www.godfreyhirst.com/nz
Phone: 0800 500 210

Manufacturer:

This information can be found in our current manufacturing statement for [Godfrey Hirst carpets](#) and [Feltex Carpets](#).

DESCRIPTION OF BUILDING PRODUCT

This BPIR Declaration relates to Godfrey Hirst, Feltex, and Mohawk carpets with surface fibers of nylon, wool, polyester, polypropylene and triexta. A carpet is a textile floor covering typically consisting of an upper layer of pile attached to a backing. The pile usually consists of twisted tufts that are typically heat-treated to maintain their structure. The carpet is intended for indoor floor use only. Manufacturing methods include Tufted and Woven sheet carpets that range in width from 1.95m to 4.0m. These sheet products are stored and supplied as rolls.

Triexta: <https://www.godfreyhirst.com/nz/product-types/triexta-carpet>

Wool: <https://www.godfreyhirst.com/nz/product-types/wool-carpet>

Polyester: <https://www.godfreyhirst.com/nz/product-types/polyester-carpet>

Nylon: <https://www.godfreyhirst.com/nz/product-types/solution-dyed-nylon-carpet>

CONTRIBUTION TO BUILDING WORK CODE OBLIGATIONS

- B2 Durability
- C3 Fire affecting areas beyond the fire source
- D1 Access Routes
- F2 Hazardous Building Materials
- G6 Impact and Airborne Sound (In a high-rise apartment where sound may be an issue)

Explore the following pages for evidence demonstrating how Godfrey Hirst NZ Ltd. products adhere to building codes and actively contribute to compliance through their inherent properties and impact after installation.

For testing data and compliance information, please refer to the Product Spec Sheet located on the individual product web pages under the 'Downloads' tab. Visit www.ghcommercial.com/nz

B2 Durability

Amendment 12 - 28/11/2019

<https://www.building.govt.nz/building-code-compliance/b-stability/b2-durability/>

Objective

B2.1 “The objective of this provision is to ensure that a building throughout its life will continue to satisfy the other objectives of this code”.

Performance

B2.3.1 (c) 5 Years if:

- 1.1. The building elements (including services, linings, renewable protective coatings and fixtures) are easy to access and replace and
- 1.2. Failure of those building elements to comply with the building code would be easily detected during normal use of the building.

Verification B2/VM1

- 1.1. In service History
- 1.2. Laboratory testing

Godfrey Hirst Product Compliance

- 1.1. Warranty: All products meet a minimum 5 years durability requirement. All Godfrey Hirst floors carry a warranty supported by New Zealand after-sales service. The Godfrey Hirst warranty applies to all Godfrey Hirst carpets sold in New Zealand. As a New Zealand carpet manufacturer and flooring distributor, we endorse and recognize all rights of the consumer under the Consumer Guarantees Act 1993 (the “CGA”) and further agree to match any performance guarantee or warranty offered in the marketplace, at the time of purchase, on any product which is equivalent to ours, where that performance guarantee or warranty offers rights to the consumer in addition to those in the CGA.
- 1.2. Broadloom Carpets are classified under the ACCS labeling system according to their durability and appearance retention. The yellow and blue labels identify carpets that have been graded for residential use. Residential ratings can have a maximum of six stars. The Star system of rating allows you to quickly decide which carpet is suitable for your needs. The gold and black labels identify carpets graded for contract or commercial use. Contract ratings can have a maximum of four stars. Some carpets will carry both Residential and Contract gradings.
- 1.3. The polyester and polypropylene carpets offered by Godfrey Hirst NZ Ltd. have not undergone evaluation by the Australian Carpet Classification Scheme (ACCS) as of now. Both Godfrey Hirst and Feltex carpets come with a manufacturer’s wear grading and warranty.

Installation Requirements

<https://www.godfreyhirst.com/nz/news/carpet-care-guide>

Godfrey Hirst Carpet should be installed in accordance with Godfrey Hirst Installation instructions available online and in accordance with AS/NZS 2455.1.2007. For a quality finish please ensure the carpet is installed by a professional tradesperson. If the carpet is improperly installed this may void the Godfrey Hirst warranty.

Maintenance

<https://www.godfreyhirst.com/nz/news/carpet-care-guide>

Please refer to the Godfrey Hirst care and maintenance guidelines for Broadloom Carpet. It is the homeowner’s responsibility to be familiar with and abide by the care requirements of their chosen carpet. Incorrect maintenance and care of the carpet may void the warranty.

Limitations

- 1.1. Broadloom Carpet is designed for interior use only.
- 1.2. The relative humidity measurable in the subfloor at the time of installation may not exceed that nominated in AS/NZS2455.1.2007 or that nominated in the Godfrey Hirst installation instructions.

C3 Fire affecting areas beyond the source

Amendment 2 - 05/11/2020

<https://www.building.govt.nz/building-code-compliance/c-protection-from-fire/c3-fire-affecting-areas-beyond-the-source/>

Objective

The objectives of clauses C2 to C6 are to:

(a) safeguard people from an unacceptable risk of injury or illness caused by fire.

Performance:

C3.4 (b) floor surface materials in the following areas of buildings must meet the performance criteria specified below:

Area of building	Minimum critical radiant flux when tested to ISO 9239-1: 2010	
	Buildings not protected by an automatic fire sprinkler system	Buildings protected with an automatic fire sprinkler system
Sleeping areas and exit ways in buildings where care or detention is provided.	4.5kW/m ²	2.2kW/m ²
Exit ways in all other buildings.	2.2kW/m ²	2.2kW/m ²
Fire cells accommodating more than 50 persons.	2.2kW/m ²	1.2kW/m ²
All other occupied spaces except household units.	1.2kW/m ²	1.2kW/m ²

Verification

Laboratory testing

Godfrey Hirst Product Compliance

Available for all Godfrey Hirst flooring products, performed by verifiable, independent testing authority. Results noted on product data sheets and test reports are available on request. Determination of burning behavior using a radiant heat source. Higher critical radiance flux levels are desirable. This indicates the burning behavior of the material being tested.

All Nylon, Wool, and Triexta carpets covered by this statement have been tested following the Broadloom Carpet test method - ISO 9239-1:2010 Flammability and smoke value.

Please take note that the polyester and polypropylene carpets available from Godfrey Hirst NZ Ltd. are not suitable floor coverings for occupied spaces that require a minimum CRF value of 1.2kW/m² or higher.

D1 Access Routes

Amendment 6 – 01/01/2017

<https://www.building.govt.nz/building-code-compliance/d-access/d1-access-routes/>

Objective

The objective of this provision is:

(a) Safeguard people from injury during movement into, within and out of buildings.

Performance

2.0. Access Routes D1.3.3(d): Access routes shall have adequate slip-resistant walking surfaces under all conditions of normal use.

Exemptions

- a) Situations where safety matting is provided as described in 2.1.5
- b) For housing this requirement applies only to the access route on the approach to the main entrance and not inside that entrance and not on the approach to other entrances. The internal access routes of housing, including kitchens and bathrooms, shall be assumed to be dry in normal use.

Godfrey Hirst Product Compliance

All Broadloom carpets are an acceptable solution as defined under D1/AS1, 2.1.2 (b)

F2 Hazardous Building Materials

Amendment 3 - 01/01/2017

<https://www.building.govt.nz/building-code-compliance/f-safety-of-users/f2-hazardous-building-materials/>

Objective

The objective of this provision is to

F2.2 To safeguard people, from injury and illness caused by exposure to hazardous building materials.

Performance

The quantities of gas, liquid, radiation or solid particles emitted by materials used in the construction of buildings, shall not give rise to harmful concentrations at the surface of the material where the materials is exposed, or in the atmosphere of any space.

Verification

Laboratory Testing

Godfrey Hirst Production Compliance

Results are noted on product data sheets where applicable and test reports are available on request.

Accreditation

Manufactured under a quality environmental system certified and complying with ISO 9001 and ISO 14001 by an accredited certification body.

All Godfrey Hirst and Feltex Nylon, Triexta, and Wool broadloom carpets receive an ACCS ECS Level 4 Environmental grading.

At present, the polyester and polypropylene carpets available from Godfrey Hirst NZ Ltd. have not been assessed under the Australian Carpet Classification Scheme (ACCS) and consequently do not possess an ECS certification.

G6 Impact and Airborne Sound

Amendment 2 - 01/12/1995

<https://www.building.govt.nz/building-code-compliance/g-services-and-facilities/g6-airborne-and-impact-sound/>

Objective

The objective of this provision is to:

G6.1. Safeguards people, from injury and illness or loss of amenity because of undue noise being transmitted between abutting occupancies.

G6.2. Prevention of undue noise transmission in building elements between occupancies or common spaces in household units.

Performance

G6.3.1 The sound transmission class of walls, floors and ceilings shall be no less than IIC 55
 G6.3.2 The impact isolation class of floors shall be no less than IIC 55

Carpet on underlay forms part of the acceptable solution for the G6 clause of the building code.

Verification

Laboratory Testing

Godfrey Hirst Product Compliance

Carpet installed on underlay – as shown below - is part of an Acceptable Solution G6/AS1 1.0.3(b).

DETAIL 5 STC 55
IIC 55

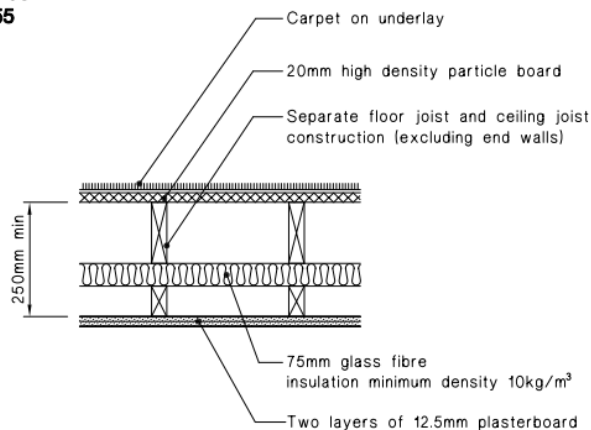

DETAIL 6 STC 55
IIC 55

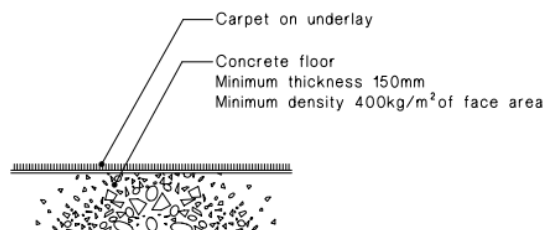

Responsible Person



In accordance with Regulation 8, as the responsible person, I confirm that the information supplied in this declaration is based on information supplied to the company by verifiable independent testing authorities as well as the company's own processes and is therefore, to the best of our knowledge, correct.

I can also confirm that none of the broadloom carpet products referred to in this declaration and distributed by Godfrey Hirst NZ Ltd. are under any ban outlined in Section 26 of the Building Act.

Signed for and on behalf of Godfrey Hirst NZ Ltd.

A handwritten signature in blue ink, appearing to be 'A May', written over a light blue horizontal line.

Andre May
General Manager Godfrey Hirst NZ

December 2023